

PERMIT

CITY OF NAPOLEON - BUILDING DEPARTMENT

255 West Riverview Avenue, Napoleon, Ohio 43545 - 419-592-4010

Permit No. 01074 Issued Aug. 16, 1985
date

Job Location 1025 Stevenson
address

Lot _____
sub-div or legal discript

Issued By Richard G. Hayman
building official

Owner Virgil Zachrich
name tel.

Address 205 E. Riverview

Agent Owner
builder-eng.-etc. tel.

Address _____

Description of Use New detached 18 X 26 garage

Residential Single
no. dwelling units

Commercial _____ Industrial _____

New _____ Add'n. _____ Alter _____ Remodel _____

Mixed Occupancy _____

Change of Occupancy _____

Estimated Cost \$ 3327.00

FEES	BASE	PLUS	TOTAL
BUILDING			12.00
ELECTRICAL			6.00
PLUMBING			
MECHANICAL			
DEMOLITION			
ZONING			
SIGN			
WATER TAP			
SEWER TAP			
TEMP. ELECT.			
ADDITIONAL PLAN REVIEW	Struct. _____ hrs		
	Elect. _____ hrs		
TOTAL FEES.....			18.00
LESS MIN. FEES PAID			-0-
	<small>date</small>		
BALANCE DUE.....			18.00

ZONING INFORMATION

district	lot dimensions	area	front yd	side yds	rear yd
A					
max hgt	no pkg spaces	no ldg spaces	max cover	petition or appeal req'd	date appr

WORK INFORMATION:

Size: Length _____ Width _____ Stories _____ Ground Floor Area _____

Height _____ Building Volume (for demo. permit) _____ cu. ft.

Electrical: _____
brief description

Plumbing: _____
brief description

Mechanical: _____
brief description

Sign: _____ Dimensions _____ Sign Area _____
type

Additional Information: _____

Date Aug 20/85 Applicant Signature Virgil Zachrich
owner-agent

CITY OF NAPOLEON
 AUG 20 1985
PAID

PERMIT

CITY OF NAPOLEON - BUILDING DEPARTMENT

255 West Riverview Avenue, Napoleon, Ohio 43545 - 419-592-4010

Permit No. 01074 Issued Aug. 16, 1985
date

Job Location 1025 Stevenson
address

Lot _____
sub-div or legal discript

Issued By Richard G. Hayman
building official

Owner Virgil Zachrich
name tel.

Address 205 E. Riverview

Agent Owner
builder-eng.-etc. tel.

Address _____

Description of Use New detached 18 X 26 garage

Residential Single
no. dwelling units

Commercial _____ Industrial _____

New _____ Add'n. _____ Alter _____ Remodel _____

Mixed Occupancy _____

Change of Occupancy _____

Estimated Cost \$ 3327.00

FEES	BASE	PLUS	TOTAL
<input type="checkbox"/> BUILDING			12.00
<input type="checkbox"/> ELECTRICAL			6.00
<input type="checkbox"/> PLUMBING			
<input type="checkbox"/> MECHANICAL			
<input type="checkbox"/> DEMOLITION			
<input type="checkbox"/> ZONING			
<input type="checkbox"/> SIGN			
WATER TAP			
SEWER TAP			
TEMP. ELECT.			
ADDITIONAL PLAN REVIEW	Struct. _____ hrs	Elect. _____ hrs	
TOTAL FEES.....			18.00
LESS MIN. FEES PAID _____ <small>date</small>			-0-
BALANCE DUE.....			18.00

ZONING INFORMATION

district <u>A</u>	lot dimensions	area	front yd	side yds	rear yd
max hgt	no pkg spaces	no ldg spaces	max cover	petition or appeal req'd	date appr

WORK INFORMATION:

Size: Length _____ Width _____ Stories _____ Ground Floor Area _____

Height _____ Building Volume (for demo. permit) _____ cu. ft.

Electrical: _____
brief description

Plumbing: _____
brief description

Mechanical: _____
brief description

Sign: _____ Dimensions _____ Sign Area _____
type

Additional Information: _____

Date Aug 20/85 Applicant Signature Virgil Zachrich
owner-agent

CITY OF NAPOLEON
 AUG 20 1985
PAID

CITY OF NAPOLEON
BUILDING INSPECTION DEPARTMENT
APPLICATION FOR BUILDING PERMIT
(Please print or type)

The undersigned hereby makes application for construction, installation, or alteration work as herein specified, agreeing to do all such work in strict accordance with the City of Napoleon's adopted Building Codes.

Location of project 1025 STEVENSON Cost of project \$3327.00
Owner's Name VIRGIL ZACHARICH Address 205 E. RIVERVIEW
Contractor OWNER Telephone No. _____
Address _____

Lot Information: (Not required for siding job)

Lot No. _____ Subdivision _____
Zoning District A Lot Size _____ ft. X _____ ft. Area _____ sq. ft.
Setbacks: Front _____ Right Side _____ Left Side _____ Rear _____

Work Information:

Residential Single Commercial _____ Industrial _____
New Construction _____ Addition _____ Remodel _____
Accessory Building GARAGE Siding _____

Brief Description of Work: ----- BUILD NEW 18 X 26 GARAGE
Detached

Size: Length _____ Width _____ No. of Stories _____
Area: 1st Floor _____ sq. ft. Basement _____ sq. ft.
2nd Floor _____ sq. ft. Accessory Bldg. _____ sq. ft.
3rd Floor _____ sq. ft. Other _____ sq. ft.

Additional Information: _____

APPLICATION FOR PERMIT SHALL BE ACCOMPANIED BY TWO COMPLETE SETS OF PLANS INCLUDING: ELEVATIONS, FLOOR PLANS, CROSS SECTIONS AND PLOT PLAN. IF ADDITION OR REMODELING, SHOW ALL EXISTING STRUCTURES AND THEIR SIZE AND LOCATION. ALL PLANS SHALL BE DRAWN TO SCALE.

Date _____ Applicant's Signature _____

PERMIT NO. 1074
PERMIT FEE \$ 12.00

PLOT PLAN

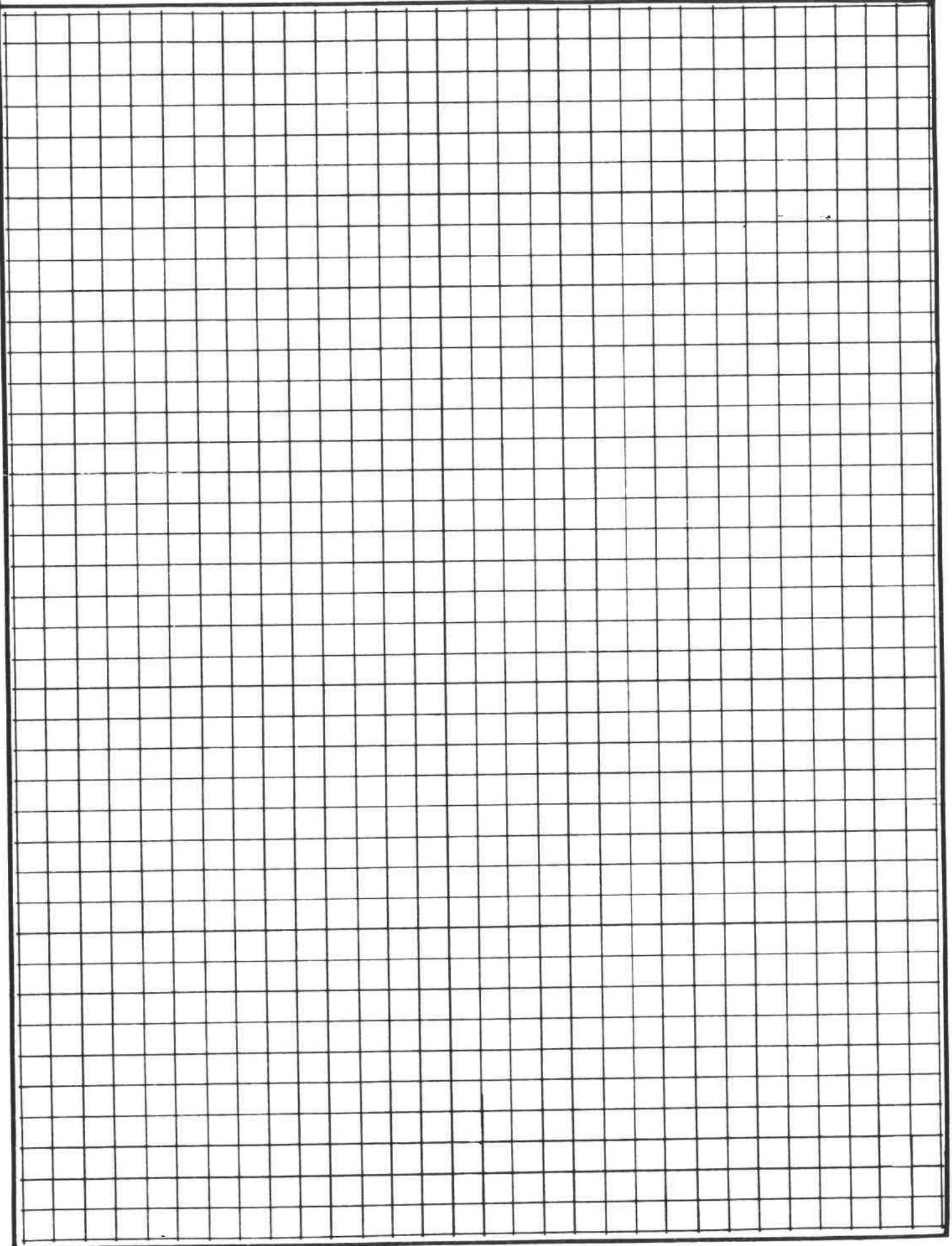

CITY OF NAPOLEON
BUILDING INSPECTION DEPARTMENT
APPLICATION FOR ELECTRICAL PERMIT
(Please print or type)

The undersigned hereby makes application for installation or replacement of electrical equipment as herein specified, agreeing to do all such work in strict accordance with the City of Napoleon's adopted Electrical Codes.

Owner's Name VIRGIL SACHRICH Address 205 E. Riverwood

Electrical Contractor Owner Telephone No. _____
Address _____

General Contractor Owner Telephone No. _____
Address _____

Location of Project 1025 STRUBANSOZ Cost of Project \$ 33 27.00

Work Information:

Residential SINGLE Commercial _____ Industrial _____
No. Units _____
New _____ Service Change _____ Rewiring _____ Additional Wiring _____

Brief Description of Work: WIRING NEW GARAGE 1 Bay
1 Light

Size of proposed service entrance _____ Number of new circuits 1

Type of proposed service entrance _____ Underground _____ Overhead _____

Require Temporary Electric _____ (Yes or No)

Total Floor Area - Commercial and Industrial only _____ sq. ft.

Additional Information: _____

*Ground fault circuit interrupter protection is required on all 120-volt single phase, 15 and 20 amp. Circuits which are part of a temporary electric service; and also on bathroom, outdoor, and garage receptacles in all dwelling units. Art. 210-8 N.E.C.

*Application for permit shall be accompanied by two complete sets of plans including: Electrical layout and riser diagram. (For commercial and industrial work only).

Date _____ Applicant's Signature _____

PERMIT NO. 1074
PERMIT FEE \$ 6.00

ALLR 4
65

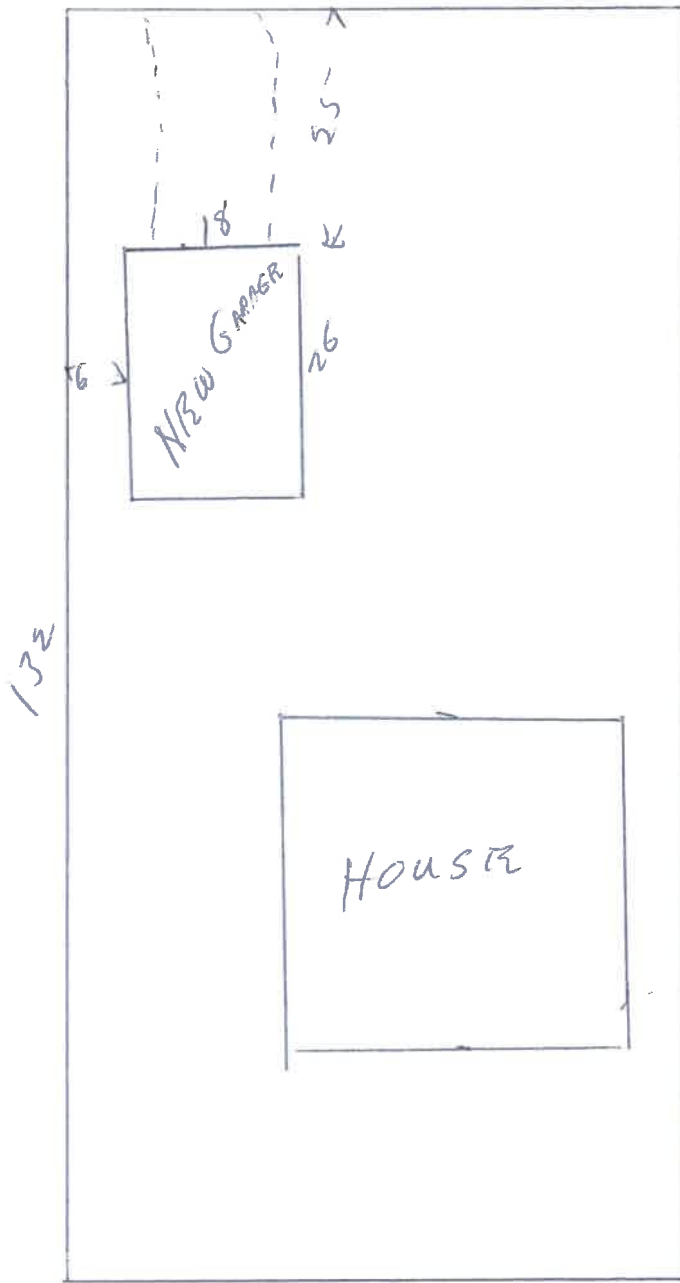

1025 STRVENSON

